

EN 54-4

EN 12101-10

Power Supply Equipment

EST-PSM48 Power Supply Manager

EST-PS48800 Power Supply Unit / EST-PF4 Power Frame

Power Supply Manager / Front

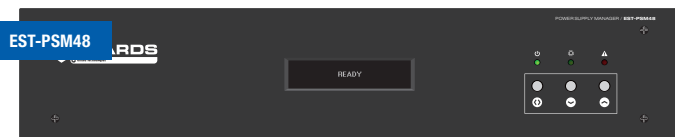

Power Supply Manager / Back

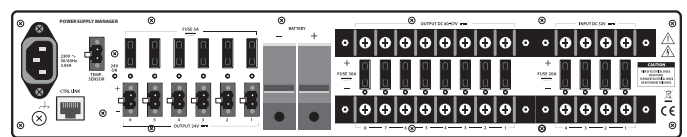

Power Frame / Front



Power Supply Units / Back

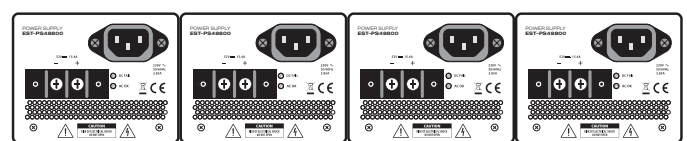

EST-PSM48 Power Supply Manager is designed for distribution of DC Power Supply from Power Supply Units (PSU) and a back-up battery. The unit controls battery charging and distributes power supply to all Voice Evacuation System (VES) equipment at max 60 A. When the system uses battery back-up, the power supplied is 3.2 kW (48 V).

The unit complies with the EN 54-4 VES standards and also EN 12101-10 Smoke and Heat Control System standards.

As a main source of energy distribution, the manager uses external modules 800 W (EST-PS48800) for 48 V.

As a source of stand-by power supply it uses the battery bank of the capacity of up to 200 Ah.

EST-PSM48 cooperates with the 4x 12V VRLA battery bank. It maintains the bank in charged condition, ensures temperature compensation of charging parameters and monitors serial resistance of the battery and its wiring as specified in Exhibit No. A2 to the EN 54-4 Standard.

EST-PSM48 co-operates with up to 4 modules of EST-PS4880 Power Supply Units. The manager ensures safe connection for the purpose of parallel operations and monitors the output parameters of each power supply unit.

EST-PS48800 is designed for assembling in a dedicated EST-PF4 Power Supply Unit Frame. The elements of the system are designed for assembling in a Rack 19" IP30-type.

	EST-PSM48
Maximum configuration	1x EST-PSM48 – Power Supply Manager 4x EST-PS4880 – Power Supply Unit 1x EST-PF4 – Power Supply Units Frame
AC power supply	230 VAC + 10%-15%; 50/60 Hz
Max nominal power consumption	885 W / 3.85 A
Efficiency at rated power	> 90%
DC input	4; bolted terminals; dedicated power supply unit EST-PS48800
DC input protection	4x20 A 58 V DC
DC outputs	8x 48V, each output max 30 A (total for all 8 outs max. 63 A)
Summary maximum DC output load (24 V and 52 V)	3200 W
Battery (type)	4 pieces, VRLA 12 V 15-200 Ah
Charging current	max. 14 A
Charging voltage	54,6 V ± 0,6 V (at 25°C)
Maximum resistance of wiring and fuses	10 mΩ
Maximum total serial resistance of wiring, fuses, and batteries	28 – 100 mΩ
Operating temperature	-5°C up +40°C
Dimensions	482 (W) x 85 (H) x 443 (D)
Weight	7,2 kg

	EST-PS48800
AC power supply	230 VAC +10% -15%, 50/60Hz, 3.85 A Wire with IEC 60320 C13 3x0,75 mm ² coupling (supplied with the unit)
Maximum power consumption	885 W / 3.85 A
Efficiency at rated power	> 90%
AC input protection	T6.3 A/250 V 5x20mm slow-blow fuse (accessed when the casing is open)
Protection from electric shock	Class I (EN 60065)
DC output	52 VDC; max. 15.4 A
Dimensions	85 (W) x 95 (H) x 395 (D)
Weight	2,6 kg